

USO: Para empalme horizontal de un conductor terminal a una platina terminal.

TAMAÑOS ESTANDAR: Conductores desde cable 8 AWG a 1000 MCM
platinas desde 1/8" X 1" hasta 7/16" X 2".

USE: For horizontal union of terminal cable to a terminal LUG.

STANDARD SIZES: Conductors from 8 AWG to 1000 MCM terminal lugs
from 1/8" X 1" to 7/16" X 2".

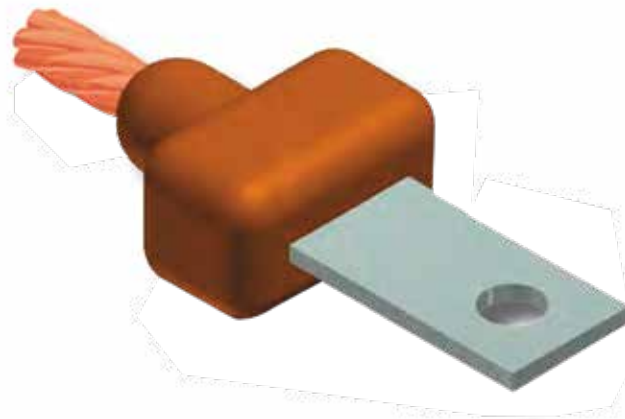

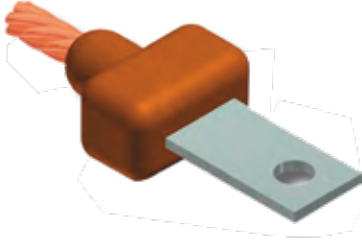

TERMINAL	CABLE	REFERENCIA REFERENCE	CARGA CARTRIDGE	TIPO
1/8" X 1"	8	SG1TN 967	45	A
1/8" X 1"	6	SG1TN 969	45	
1/8" X 1"	4	SG1TN 971	45	
1/8" X 1"	3	SG1TN 973	45	
1/8" X 1"	2	SG1TN 975	45	
1/8" X 1"	1	SG1TN 977	45	
1/8" X 1"	1/0	SG1TN 978	45	
1/4" X 1"		SG1TN 979	65	
1/8" X 1"	2/0	SG1TN 980	65	
1/4" X 1"		SG1TN 981	65	
3/16" X 1"	3/0	SG1TN 982	90	
1/4" X 1"		SG1TN 983	90	
3/16" X 1"	4/0	SG1TN 984	90	
1/4" X 1"		SG1TN 985	90	
1/4" X 1 1/4"		SG1TN 986	90	
1/4" X 1 1/2"		SG1TN 987	90	
1/4" X 1"	250 MCM	SG1TN 988	90	
1/4" X 1 1/4"		SG1TN 989	90	
1/4" X 1 1/2"		SG1TN 990	90	
1/4" X 1"	300	SG1TN 991	90	
1/4" X 1 1/4"		SG1TN 992	90	
1/4" X 1 1/2"		SG1TN 993	90	
1/4" X 1"	350	SG1TN 994	115	
1/4" X 1 1/4"		SG1TN 995	115	
1/4" X 1 1/2"		SG1TN 996	150	
1/4" X 1 1/2"	500	SG1TN 1001	200	
1/4" X 2"		SG1TN 1002	200	
3/8" X 1"		SG1TN 1003	200	
3/8" X 1 1/2"		SG1TN 1004	200	
3/8" X 2"		SG1TN 1005	2-150	
1/4" X 2"	750	SG1TN 1006	2-150	
3/8" X 1 1/2"		SG1TN 1007	2-150	
3/8" X 2"		SG1TN 1008	2-150	
3/8" X 2"	1000	SG1TN 1009	2-200	
7/16" X 2"		SG1TN 1010	2-200	
1/2" X 2"		SG1TN 1011	500	